



EXTRASOFT CONTENITORI

design Piero Lissoni

Family of modular storage units, available in two heights with open compartments of different sizes and capacities, to be combined with Extrasoft upholstered elements or usable as freestanding low tables. Made of MDF veneered in natural or charcoal-dyed oak, with 12mm thick tops and bases and 40mm thick side panels. All versions are with black adjustable PVC feet. The various elements are joined together by means of hooks.

Structure



Notes

The various elements are joined together by means of hooks to be placed in the appropriate milling, as per the instructions enclosed with the product.

Hooks for assembly with upholstered elements with standard feet in PVC.

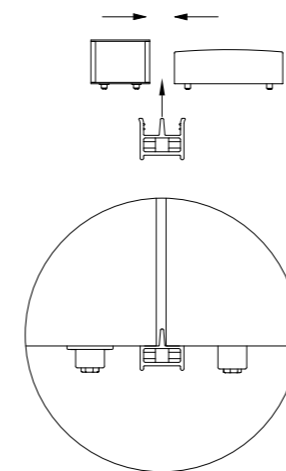

Hooks for assembly with upholstered elements with feet with spacers.

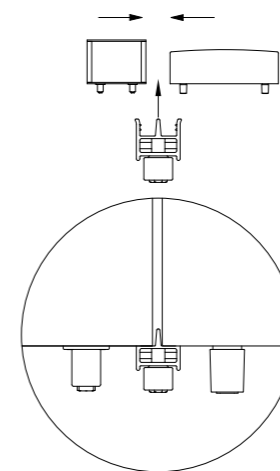

In case of using spacers for upholstered elements, it is necessary to use the foot with height 7cm (2).

Extrasoft Contenitore unit foot standard height

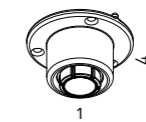

Extrasoft Contenitore unit foot height 7cm.

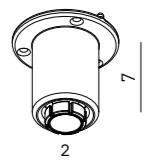

For composition with different elements, please attach a general sketch to the order.

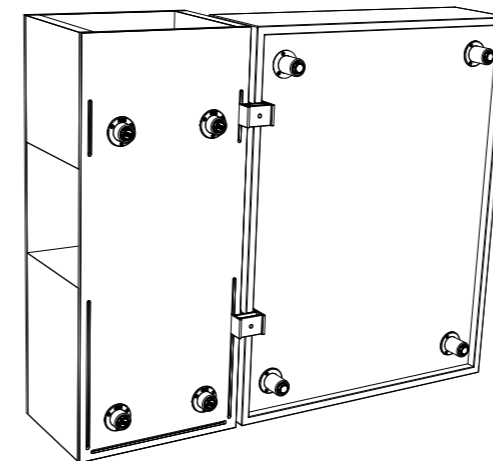

Technical Drawings

Storage unit cm.94x51 h.43-33

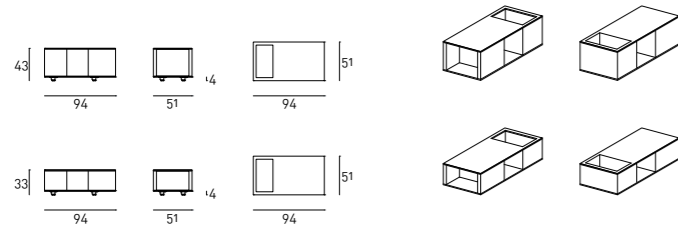

Storage unit cm.120x51 h.43-33

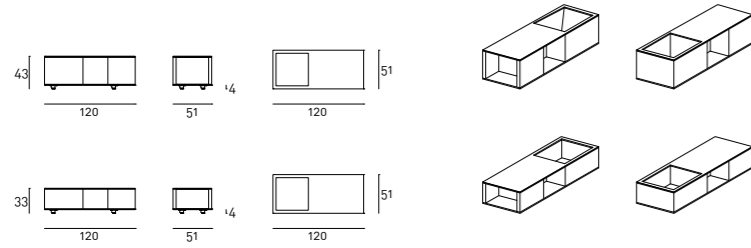

Storage unit cm.146x51 h.43-33

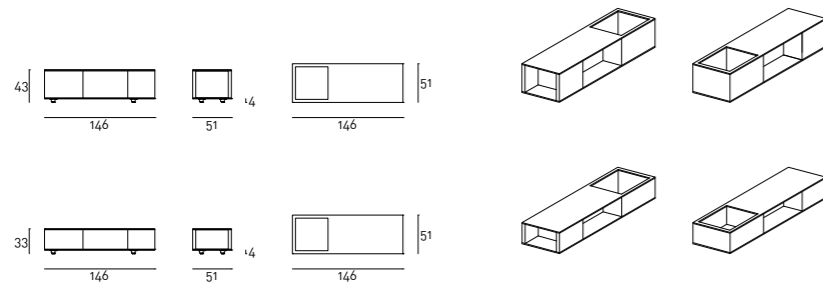

Examples of Composition

Composition 01

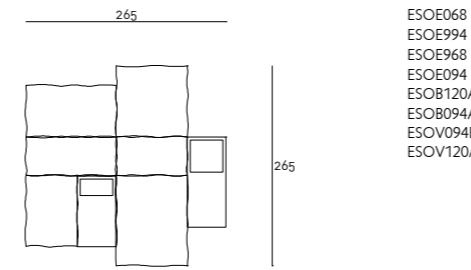

ESOE068
ESOE994
ESOE968
ESOE094
ESOB120A
ESOB094A
ESOV094B
ESOV120A

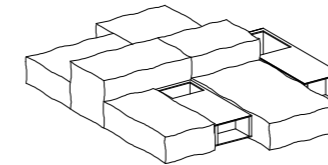

Composition 02



ESOE094
ESOE994
ESOE134
ESOE094
ESOE120
ESOE968
ESOB094A
ESOB120A
ESOV146A
ESOV094B
ESOV120A

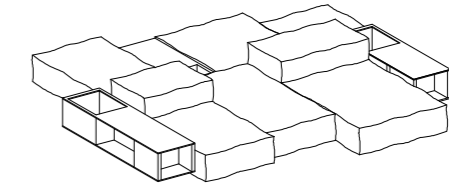

Composition 03

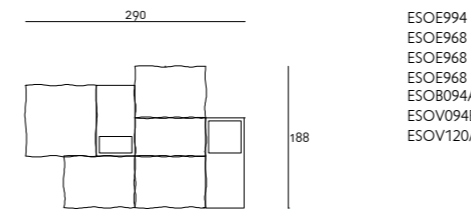

ESOE994
ESOE968
ESOE968
ESOE968
ESOB094A
ESOV094B
ESOV120A

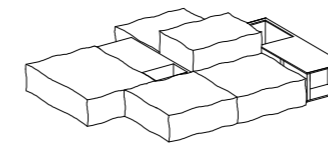

Composition 04

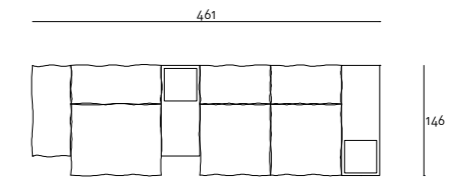

ESOE094
ESOE994
ESOE994
ESOB120B
ESOB120A
ESOB094A
ESOB094A
ESOV120B
ESOV146B

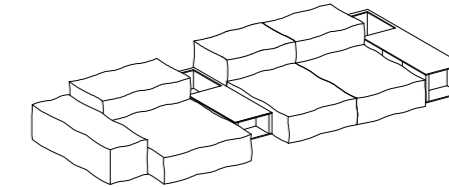

Composition 05

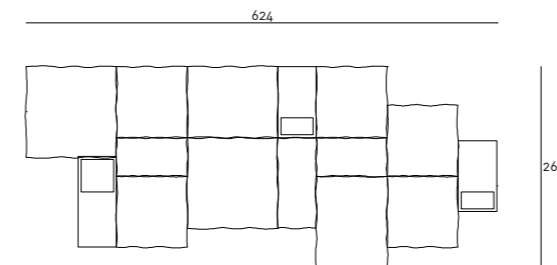

ESOE120
ESOE994
ESOE994
ESOE094
ESOE120
ESOE994
ESOE094
ESOE994
ESOE994
ESOV120A
ESOV094B
ESOV094B

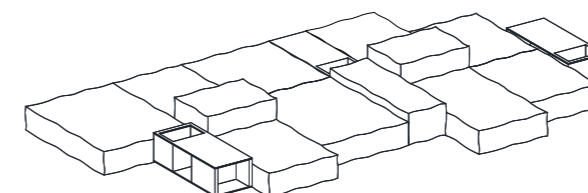

The commercial codes refer to the elements chosen in the above-proposed compositions.



